



Convertible Top Is Torn at the Lock Handle and/or the Right Rear

SYMPTOM

The convertible top is torn at one or both lock handles and/or the right rear area.

PROBABLE CAUSE

There is a rough surface on the lock handle and/or the right rear frame hinge.

VEHICLES AFFECTED

For the following VIN ranges, the convertible top may be torn at the right rear area:

2005–07 S2000 – ALL

2008 S2000 –

From VIN JHMAP...8S000001 thru
JHMAP...8S002446

For the following VIN ranges, the convertible top may be torn at the front lock assembly:

2005–08 S2000 – ALL

2009 S2000 –

From VIN JHMAP...9S000001 thru
JHMAP...9S000096

CORRECTIVE ACTION

Replace the convertible top cloth and one or both lock handles, and remove any rough spots on the right rear frame hinge.

PARTS INFORMATION

Aluminum Washer (11 required):
(commercially available)

Brass Rivets (11 required):

P/N 86320-S2A-003, H/C 6244560

Cloth Top Assembly:

P/N 86310-S2A-J03, H/C 8800005

Double-Sided Tape:

P/N 86022-S2A-003, H/C 6244214

Pop Rivet (Two required):

P/N 86006-S2A-003, H/C 6244032

Pop Rivet, 3/16"x 3/8" (11 required):

(commercially available)

Right Side Lock Assembly:

P/N 86250-S2A-J01, H/C 6857346

Left Side Lock Assembly:

P/N 86260-S2A-J01, H/C 6857353

TOOL INFORMATION

Eye protection

4 mm drill bit

Drill

Body vise grip pliers or pop rivet gun

WARRANTY CLAIM INFORMATION

In warranty: The normal warranty applies.

OP#	Description	FRT
814129	Replace the top cloth assembly.	7.5
8171D6	Replace the lock handle on one side.	0.2
A	Replace the lock handle on one additional side.	0.2
8230B4	Remove the burrs, and paint the frame hinge.	0.3

Failed Part: P/N 86310-S2A-J03
H/C 8800005

Defect Code: 07701

Symptom Code: 02602

Skill Level: Repair Technician

Out of warranty: Any repair performed after warranty expiration may be eligible for goodwill consideration by the District Parts and Service Manager or your Zone Office. You must request consideration, and get a decision, before starting work.

REPAIR PROCEDURE

1. Remove the convertible top:
 - Refer to page 20-41 of the *2000–2009 S2000 Service Manual*, or
 - Online, enter keyword **CLOTH**, and select **Convertible Top Cloth Replacement** from the list.
2. With the convertible top assembly out of the vehicle, use a white marker to draw a circle around each of the 11 rivets.

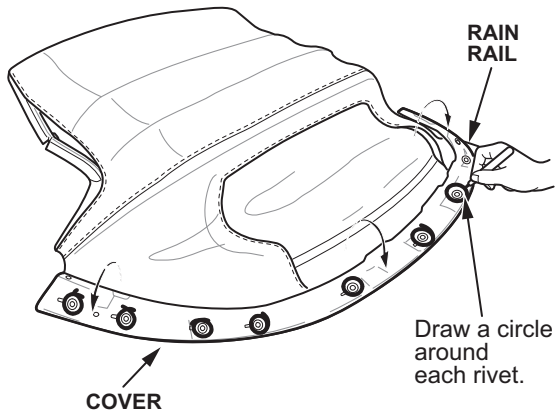

3. Pull the rain rail up, and turn it inside out.
4. Drill out the rivets on the rain rail with a 4 mm drill bit, then remove the rail.

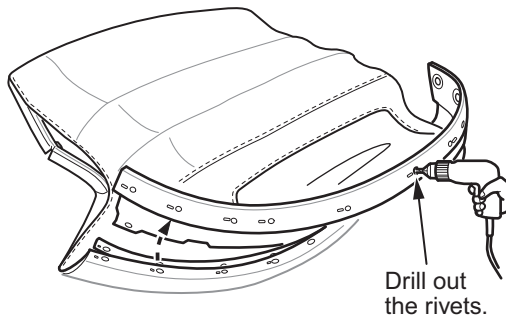

5. Pry apart the rivets that attach the rain rail to the cloth.
 - If the cloth is torn at one of the lock handles, go to step 6.
 - If the cloth is torn at the right rear area, go to step 8.

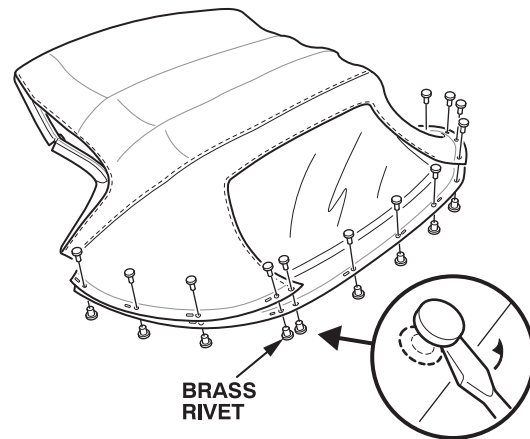

6. Remove the lock handle on the affected side(s) as shown.

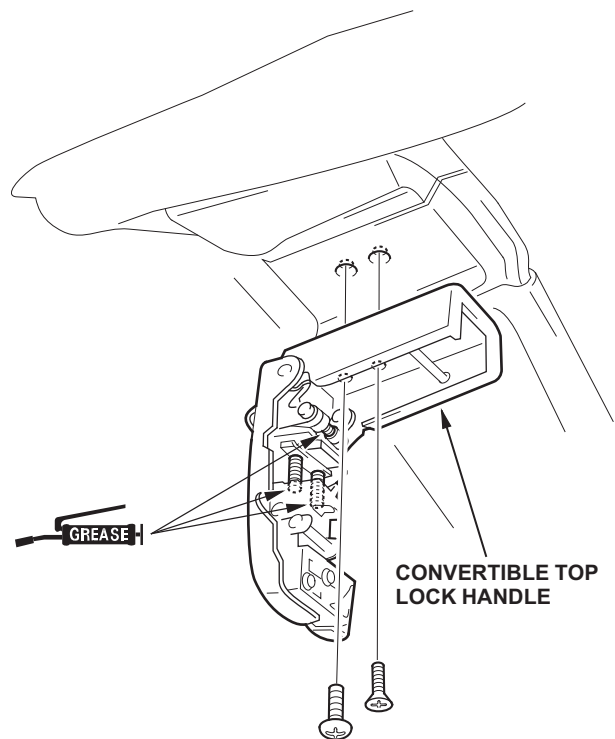

7. Install the handle(s) in the reverse order of removal, and apply multipurpose grease to its springs and moving parts. Then, go to step 11.

8. Locate the burrs at the right-rear of the frame hinge, then use a file to remove the burrs and any rough areas.



Remove all the burrs.

FRAME HINGE



9. Remove all metal particles from the hinge and the frame.
10. Prime the filed area with a commercially available primer spray paint, and allow it to dry. Finish the primed area with a flat black spray paint.

11. Reinstall the rain rail with 11 new brass rivets or with 11 commercially available pop rivets and washers. If using pop rivets, make sure the crush end of each rivet is facing the rear of the vehicle when the rain rail is in place.

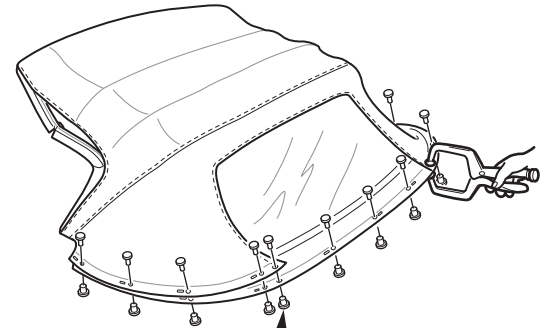

NEW TWO-PIECE BRASS RIVET

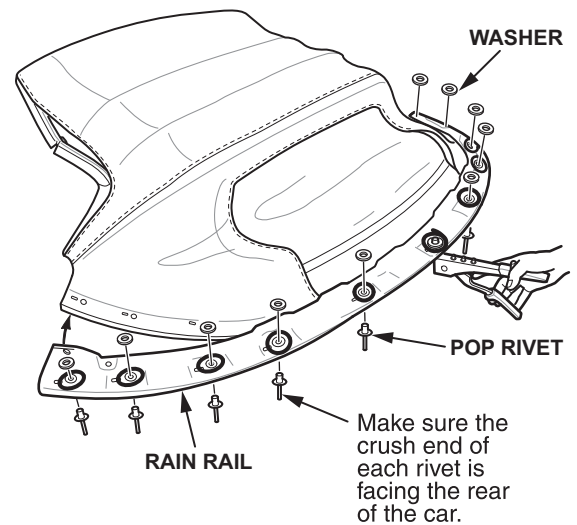

12. Reinstall the convertible top and all other removed parts.